

Series LGTR 2000



Features

- Low energy consumption
- Ideal for both static and dynamic applications
- Integrated controller with LED status indicator
- Short-circuit-proof semiconductor-output PNP/NPN (push-pull)
- Requires no grounding (earth)
- Selectable monitoring height of either 1,582 mm or 1,822 mm
- IP65 (Standard) and IP67 (waterproof) versions available
- EX-version available
- Edge can be front or side mounted



Technical data

OPTICAL

Operating range	0 ... 4 m	
Protection height	1,822 mm / 1,582 mm	
No. of optical elements	16 / 32 / 42	
No. of beams:	at 16 elements 74	at 42 elements 196
	at 32 elements 154	
Max. ambient light	100,000 Lux	

MECHANICAL

Dimensions (w × h × l)	12 × 16 × max. 2,000 mm
Housing material	aluminum
Enclosure rating	IP65
Temperature range	-40 °C ... +60 °C

ELECTRICAL

Supply voltage U_{SP}	10 ... 30 VDC
Typ. current consumption at 24 VDC (without load)	40 mA
Max. inrush current per edge	< 2 A
Output	PNP/NPN (push-pull)
Output logic	NO/NC selectable
Max. output load	120 mA, 100 nF
Typ. response time:	at 16 elements 70 ms
	at 32 elements 120 ms at 42 elements 160 ms

CONNECTION CABLE AND ELECTRICAL CONNECTION

Emitter	
Cable length	5 m
Diameter	Ø 3.5 mm
Material	PVC, black
Connection	M8, 4-pin
Plug color	White
Wires	AWG26
•brown	U_{SP}
•blue	GND (0 V)
•black	Not used
•white	Protection field height selector
Receiver	
Cable length	5 m
Diameter	Ø 3.5 mm
Material	PVC, black
Connection	M8, 4-pin
Plug color	Blue
Wires	AWG26
•brown	U_{SP}
•blue	GND (0 V)
•black	Output
•white	Selectable output logic

Order informations

Type

LGTR 2000 PNUK-16-ST3
LGTR 2000 PNUK-32-ST3
LGTR 2000 PNUK-42-ST3

Description

Light curtain system with emitter and receiver unit, 16 elements / 74 beams, cable 5 m
 Light curtain system with emitter and receiver unit, 32 elements / 154 beams, cable 5 m
 Light curtain system with emitter and receiver unit, 42 elements / 196 beams, cable 5 m

Dimensions

For 16 elements
All dimensions in mm
Proportions not to scale

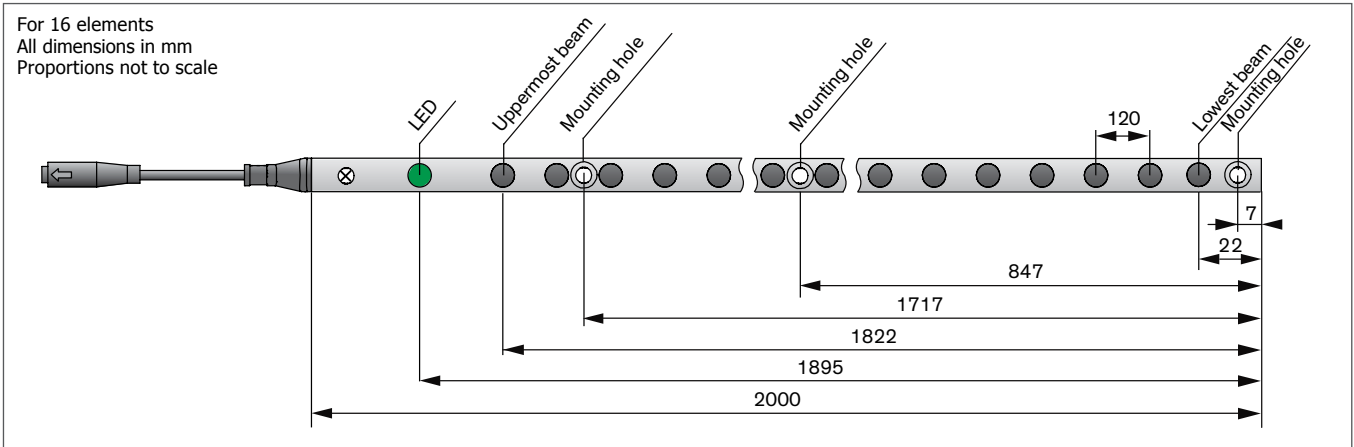

Selectable output logic

NO/NC selector connected to GND (0 V)



NO/NC selector connected to Usp or not connected



Detailed view

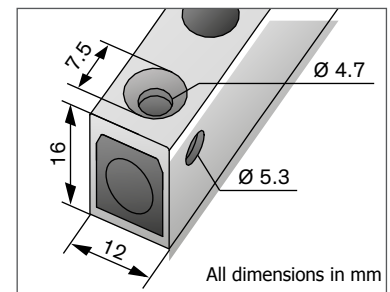

PNP / NPN output

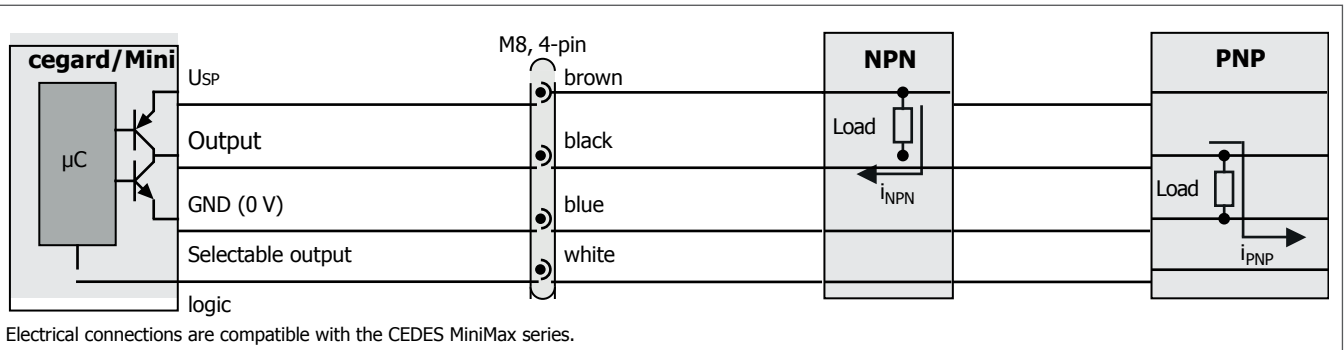

Applications

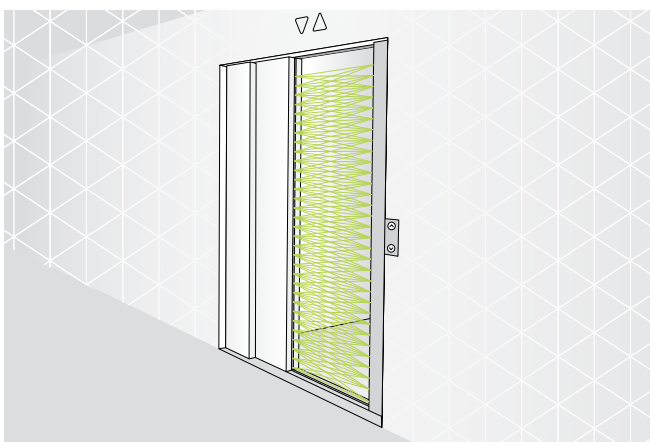

Dynamic mounting

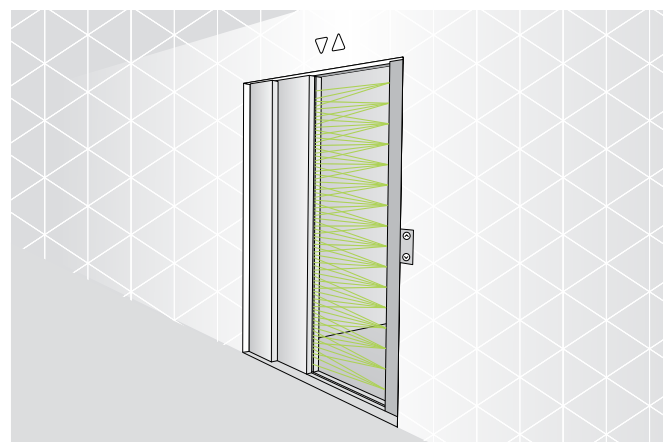

Static mounting